

Lighting for the paper industry



Sammode

● Industry
● High temperatures



Sammode's strength: complete solutions for paper factories

Resistance to high temperature up to +200°C

- Cabling and components resistant to high temperature
- Designed to withstand dilatation

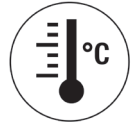

Protection against internal and external dust accumulation thanks to

- A tubular shape
- A minimum length of seal
- The use of a single central screw ensuring a consistent compression of the sealing surface



Resistance to chemical aggressions and corrosion

Thanks to the use of resistant materials:

- A choice of borosilicate glass and unique co-extruded polycarbonate/PMMA casing
- Stainless steel for all metallic external components



Robustness against shocks and vibrations

- Mechanical "Screw" closure System according to the IEC 60068-2-6 standard
- Mechanical resistance to vibrations
- IK10 impact resistance
- Robust electronic components withstanding voltage peaks up to 4kV



A commitment in time

Expert in extreme environments, Sammode is able to offer you long term sustainable solutions with a 5 years warranty in an unrestricted 24-hour operation



Selection guide

As each of your process zone is specific, we offer you products that correspond to your requirements.

Lighting in high temperature	Constraints	Products
Presses	$T_{\max} = 55^{\circ}\text{C}$	- BUNSEN
Dry section	$T_{\max} = 70^{\circ}\text{C}$	- JOULE <i>LED</i>
Finishing touches	$T_{\max} = 100^{\circ}\text{C}$	- PAULI HT100 <i>Fluorescent</i>
Winding machine	$T_{\max} = 200^{\circ}\text{C}$	- PAULI HT 200 <i>Incandescent</i>
Lighting in hazardous area		
Storage of chemical products	Atex Gas Zone 1	- SABATIER
	Atex Gas Zone 2 and dust Zone 21	- BOYLE
Emergency lighting		
EN 60598-2-22 certified	Single battery operation Central source	- MAXWELL SXH - MAXWELL 100 LSC



Pauli



Coulomb



Boyle

Sustainable and maintenance-friendly lighting

As a designer and manufacturer, Sammode is fully committed to assuring you continuous solutions with long-term and evolving lighting. Light sources, electronic circuit and metallic structure: each component is made to last and to be replaceable.

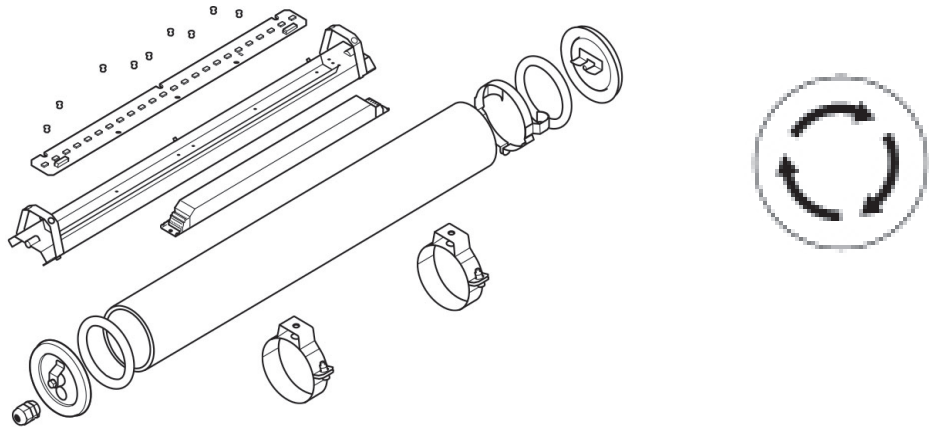

Easy installation and safe maintenance

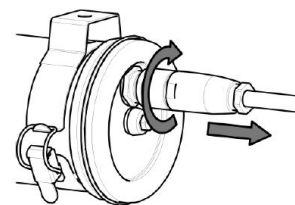
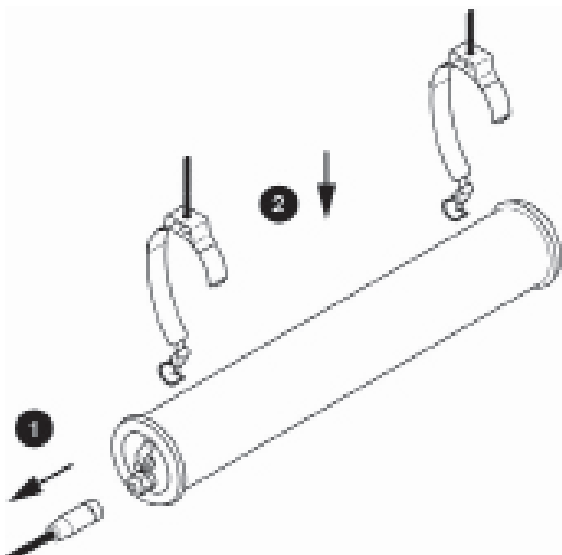

Safe maintenance outside of the area of application

- Fast opening of the retainers
- Connection via plug connector
- Assembly and disassembly without tools



Papierfabrik Cartaseta, Schweiz.

They trust us



Founded in 1927, Sammode is a family company specialized in professional lighting. For four generations we have been developing and manufacturing industrial and architectural luminaires in our factory in the French Vosges.

Our lighting solutions are well-known for their quality, performance and sustainability. They are all created and manufactured in France and are made to satisfy the needs and demands of our customers.



Sammode

Sammode S.A.

24 rue des Amandiers
F-75020 Paris
Tél. : +33 (0)1 43 14 84 90
info@sammode.com

SAMMODE LIGHTING
AUSTRALASIA PTY LTD
15 Industrial Avenue
WACOL QLD 4076
AUS - Queensland
Tel.: + 61 (0) 7 3335 3504
info@sammode.com.au